

Installation Guide for ROSTA Tensioners



Warning

- Read and follow all instructions carefully
- Disconnect and lock-out power before installation and maintenance
- Avoid contact with rotating parts
- Do not operate equipment without guards in place. Exposed equipment can result in severe injury or death
- Periodic inspections should be performed
- Missing proper maintenance can result in premature product failure and personal injury
- All work should be performed by qualified personnel and compliant with local and national safety regulations

1 Accessories installation

Tighten the accessory slightly

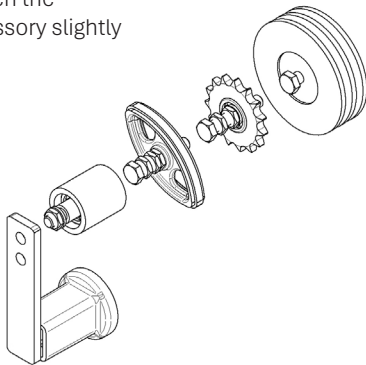

2 Tensioner mounting

SE
Standard
mounting

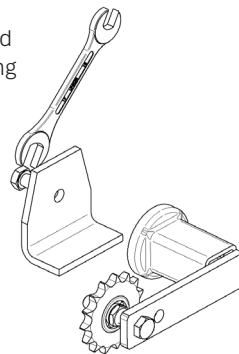

SE-F
Front mounting

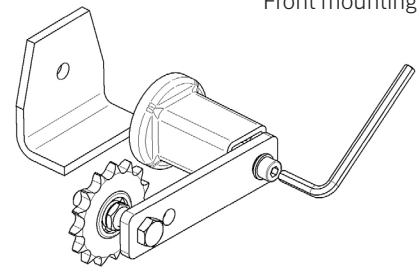

Tighten the central screw slightly

3 Accessories alignment

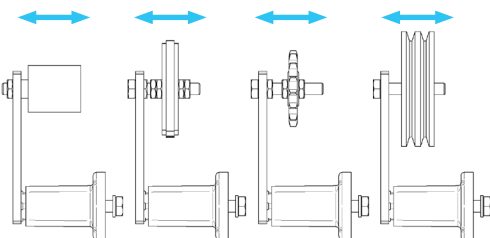

Align and tighten the accessory

4 Tensioning

Position the wrench close to the flangebottom and rotate the housing

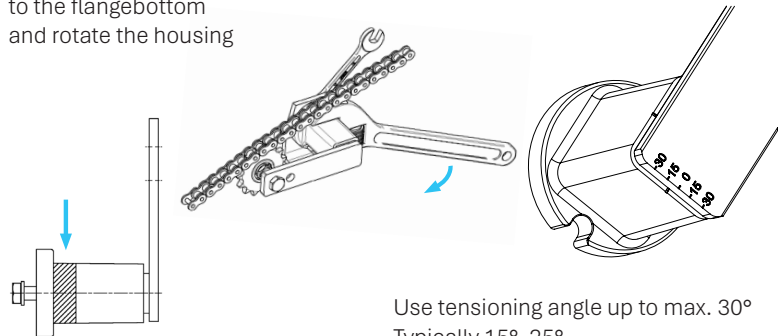

Use tensioning angle up to max. 30°
Typically 15°–25°

5 Tightening

Tighten the central screw with the standard tightening moment

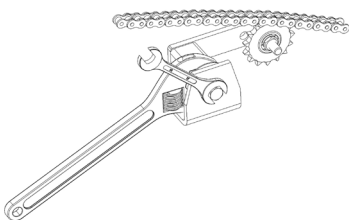

Max. permissible bolt tightening moment

| Type | Screw | Grade | Torque |
|---------------|-------|-------|----------------------|
| SE 11 | M 6 | 8.8 | 10 Nm / 7.4 lb ft |
| SE 15 | M 8 | 8.8 | 25 Nm / 18.4 lb ft |
| SE-F 15 | M 6 | 12.9 | 17 Nm / 12.5 lb ft |
| SE 18 | M 10 | 8.8 | 49 Nm / 36.1 lb ft |
| SE-F 18 | M 8 | 12.9 | 41 Nm / 30.2 lb ft |
| SE 27 | M 12 | 8.8 | 86 Nm / 63.4 lb ft |
| SE-F/SE-FE 27 | M 10 | 12.9 | 83 Nm / 61.2 lb ft |
| SE 38 | M 16 | 8.8 | 210 Nm / 154.9 lb ft |
| SE-F/SE-FE 38 | M 12 | 12.9 | 145 Nm / 106.9 lb ft |
| SE 45 | M 20 | 8.8 | 410 Nm / 302.4 lb ft |
| SE-F 45 | M 16 | 12.9 | 355 Nm / 261.8 lb ft |
| SE 50 | M 24 | 8.8 | 750 Nm / 553.2 lb ft |
| SE-F 50 | M 20 | 12.9 | 690 Nm / 508.9 lb ft |

Positioning notch

Use e.g. roller pin if necessary

