

Advantages of the new design:

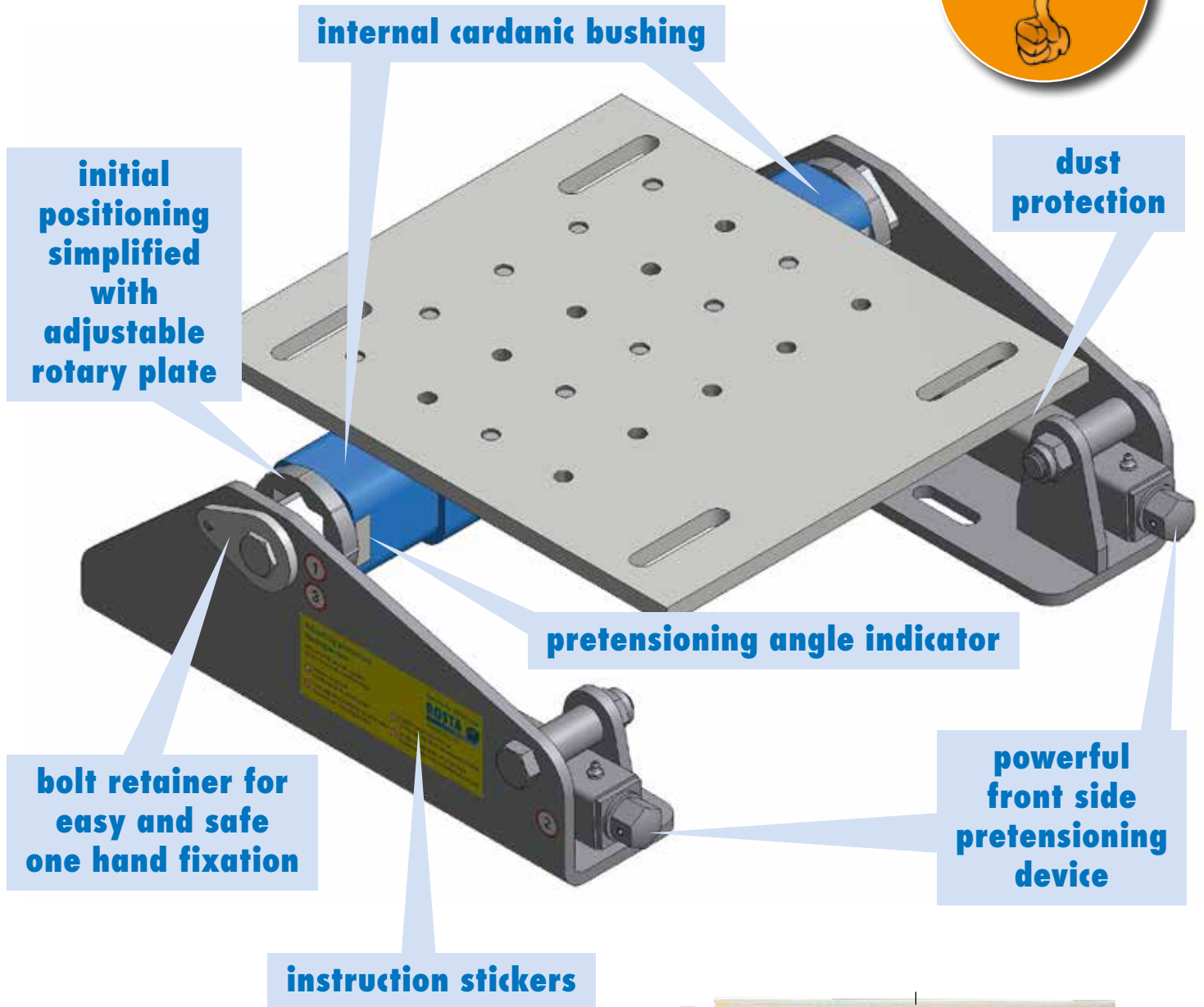

Motorbases Type MB 50 Gen 15

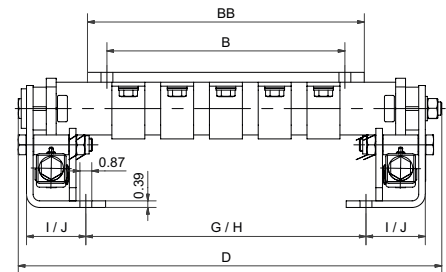
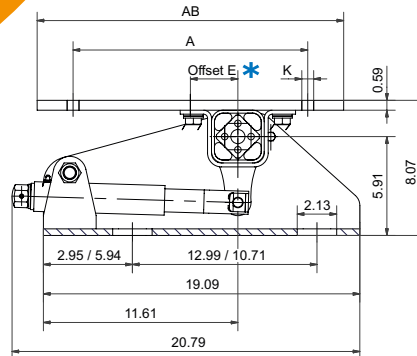
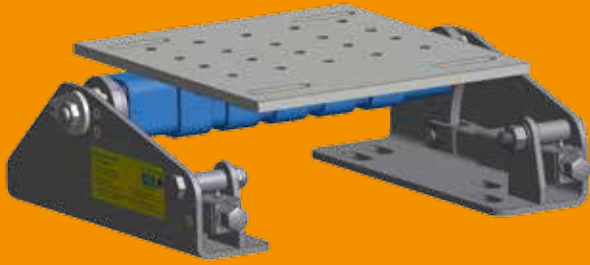

Art. No.	Type	IEC			NEMA			AB	BB	D	E	G	H	I	J		
		Motor Frame Size	A	B	K	Motor Frame Size	A									B	K
11 020 012	MB 50×270-1	160M	10.00	8.27	0.55	254T	10.00	8.27	0.55	12.60	12.40	19.41	0.98	9.25	12.80	4.33	2.56
		160L	10.00	10.00	0.55	256T	10.00	10.00	0.55								
11 020 013	MB 50×270-2	180M	10.98	9.49	0.55	284T	10.98	9.49	0.55	13.78	13.78	18.23	2.83	9.25	12.80	4.33	2.56
		180L	10.98	10.98	0.55	286T	10.98	10.98	0.55								
11 020 014	MB 50×400	200L	12.52	12.01	0.71	324T	12.52	10.51	0.71	15.94	15.35	22.17	2.17	13.19	16.73	4.33	2.56
			326T	12.52	12.01	0.71											
11 020 015	MB 50×500	225S	14.02	11.26	0.71	364T	14.02	11.26	0.71	18.31	16.54	25.31	2.83	15.16	18.70	4.33	2.56
		225M	14.02	12.24	0.71	365T	14.02	12.24	0.71								

* All ROSTA Motorbases MB 50 will be supplied with motor plate installed in "off-set" configuration. According to the final positioning of the base, the operating angle of the belts and the required tensioning travel, the motor plate can be altered in "centered" position on top of the element axis. Relevant threaded fixation holes are existent in plate.

For possibly required higher inclination of the motorplate, the rotary plate(s) can be removed and remounted 45° rotated.



- 1 Motor plate
- 2 Side supports
- 3 Pretensioning device
(MB 50×270-1 and MB 50×270-2:
1 device / MB 50×400 and
MB 50×500: 2 devices)
- 4 Rubber suspension element with cardanic bushings and brackets
(depending on size = 3–5 brackets)



ROSTA USA CORP.

1425 Kalamazoo Street
South Haven, MI 49090
Toll-free 888-506-1634
Phone 269 841-5448
Fax 269 924-0952
E-Mail info@rosta.com
Internet www.rosta.com

Mounting instructions for MB 50

1 Determine of the ideal motorbase position

Operation area "above"

Motor plate standing ~ 30° inclined

Operation area "below"

Motor plate standing ~ horizontal

- ideal position of the MB, longest tensioning travel
- sufficient tensioning travel
- contact **ROSTA**

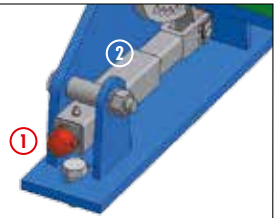
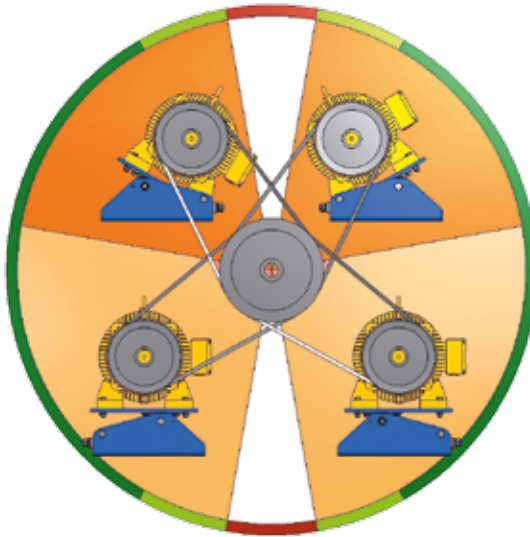

Do not use compressed-air power tools for tensioning!

WARNING

Do not remove turnbuckle when device is pre-tensioned!

2 Support fixations

4 slotted holes 0,87 x 2,13 inch

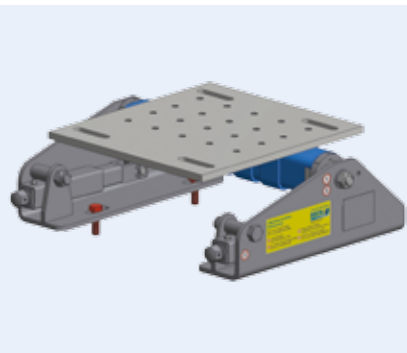

3 Alignment of pulleys and motor fixation

4 bolts according relevant motor size

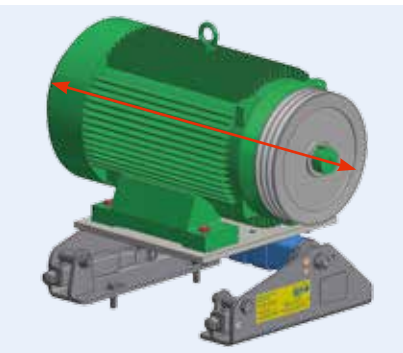

4 Loosen of the shaft bolt (element axis)

30 mm (1¼") wrench

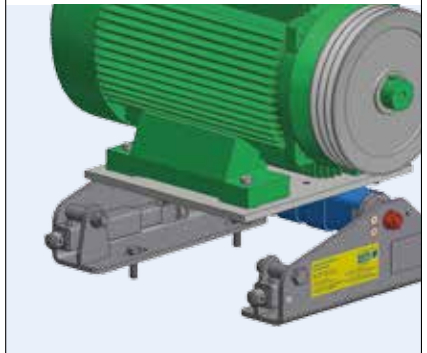

5 Insert and tension the belts, control belt test force

Tensioning of the belts according to belt suppliers recommended test force. Adjust tension with a 30 mm (1¼") wrench (uniformly if 2 pretensioning devices are supplied). The belt tension can easily be monitored according to the reference mark on the angle scale.

Operation area "below"

Operation area "above"

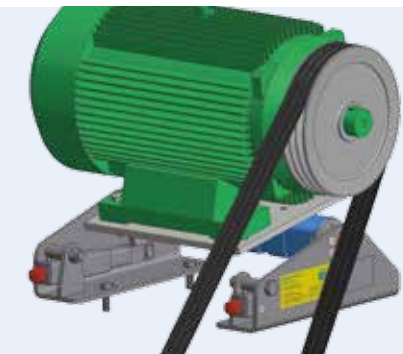
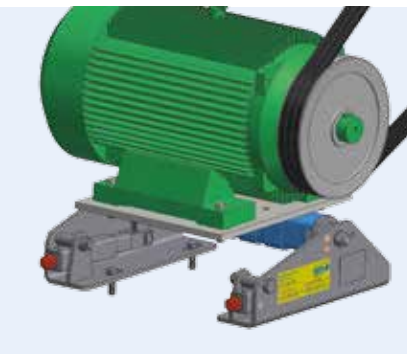

6 Tighten of the shaft bolt, start of operation

30 mm (1¼") wrench
Locking torque 410 Nm
(302,4 ft-lbs.)

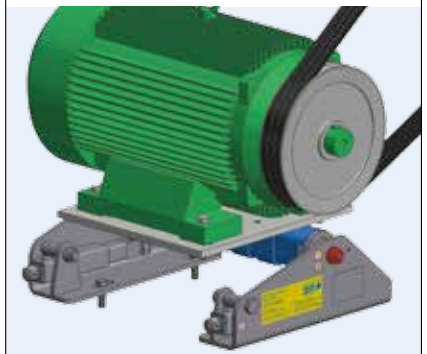

Retension:

Generally retensioning is not necessary, however, we recommend to inspect the belt tension after a few days of operation according the sticker on the side supports.



www.rosta.com